

Lever mod. Y-SA002

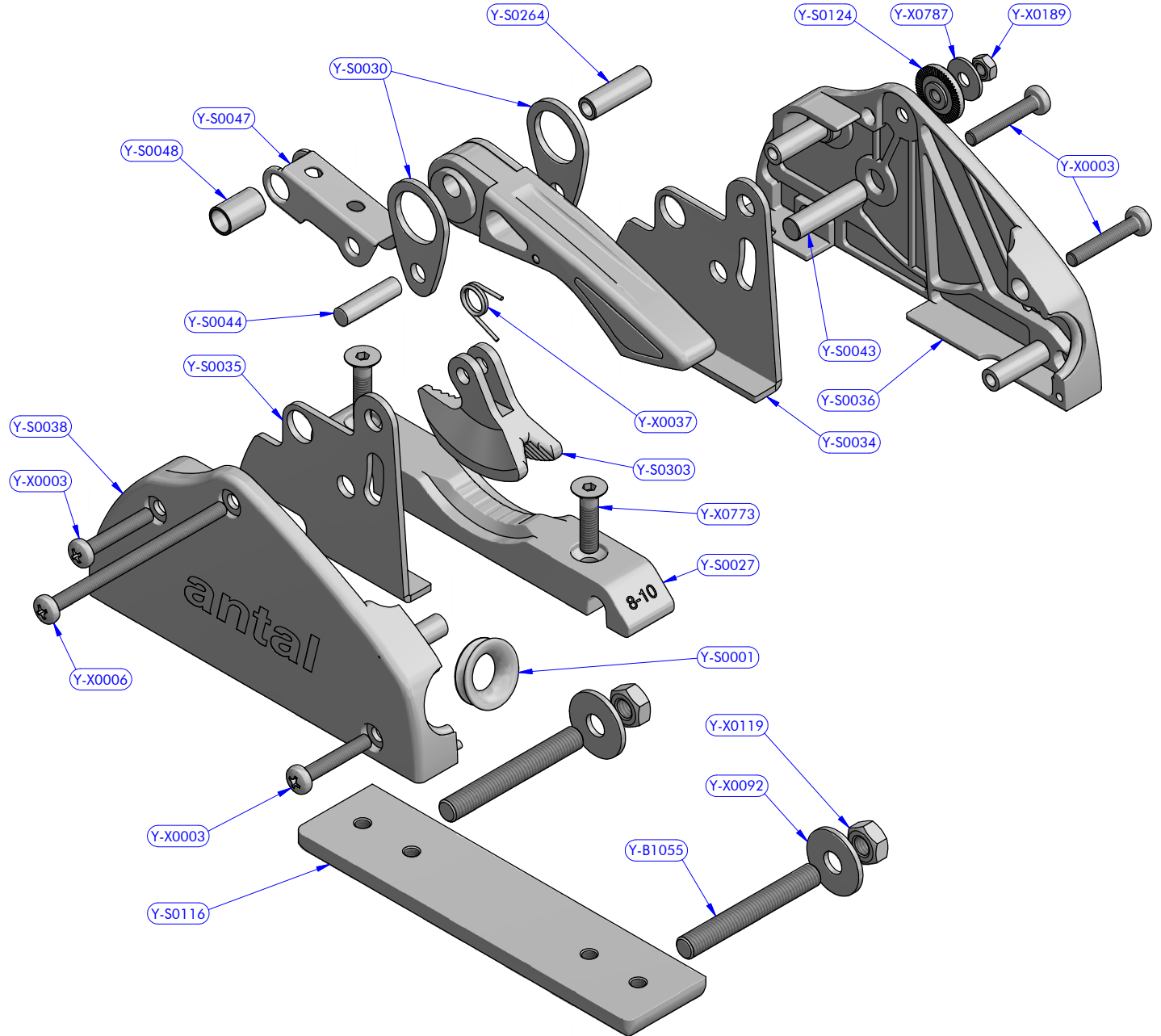

PART LIST			
CODE	DESCRIPTION	MATERIAL	Q.TY
SFD008	Delrin ball 1/8"	Plastic	2
Y-B1055	Stud	S.Steel	2
Y-S0001	Ring	Chromed brass	1
Y-S0027	Base	Aluminium	1
Y-S0030	Connecting rod	S.Steel	2
Y-S0033	Lever cap	Plastic	1
Y-S0034	Right side plate	S.Steel	1
Y-S0035	Right side plate	S.Steel	1
Y-S0036	Cheekplate	Plastic	1
Y-S0038	Cheekplate	Plastic	1
Y-S0039	Lever insert	Plastic	1
Y-S0041	Lever	Aluminium	1
Y-S0043	Spindle	S.Steel	1
Y-S0044	Spindle	S.Steel	1
Y-S0047	Cam bracket	S.Steel	1
Y-S0048	Pipe spacer	S.Steel	1
Y-S0116	Base	Aluminium	1
Y-S0124	Skirt washer	S.Steel	1
Y-S0264	Pipe spacer	S.Steel	1
Y-S0303	V-Grip Cam	S.Steel	1
Y-X0003	Screw	S.Steel	4
Y-X0006	Screw	S.Steel	1
Y-X0037	Torsion spring	S.Steel	1
Y-X0092	Washer	S.Steel	2
Y-X0119	Nut	S.Steel	2
Y-X0189	Nut	S.Steel	1
Y-X0773	Screw	S.Steel	2
Y-X0787	Washer	S.Steel	1



V-Cam 814 Series	Horizontal version
FAMILY	ARTICLE
Exploded view	
DESCRIPTION	

<b>549.111/H</b>
MODEL CODE

25/06/2019	00
DATE	REV.
19062509	1 / 1
DWG N.	PG.